

# Attachment #5 Proponent's Proposed Concept Plan

PDP 11-24

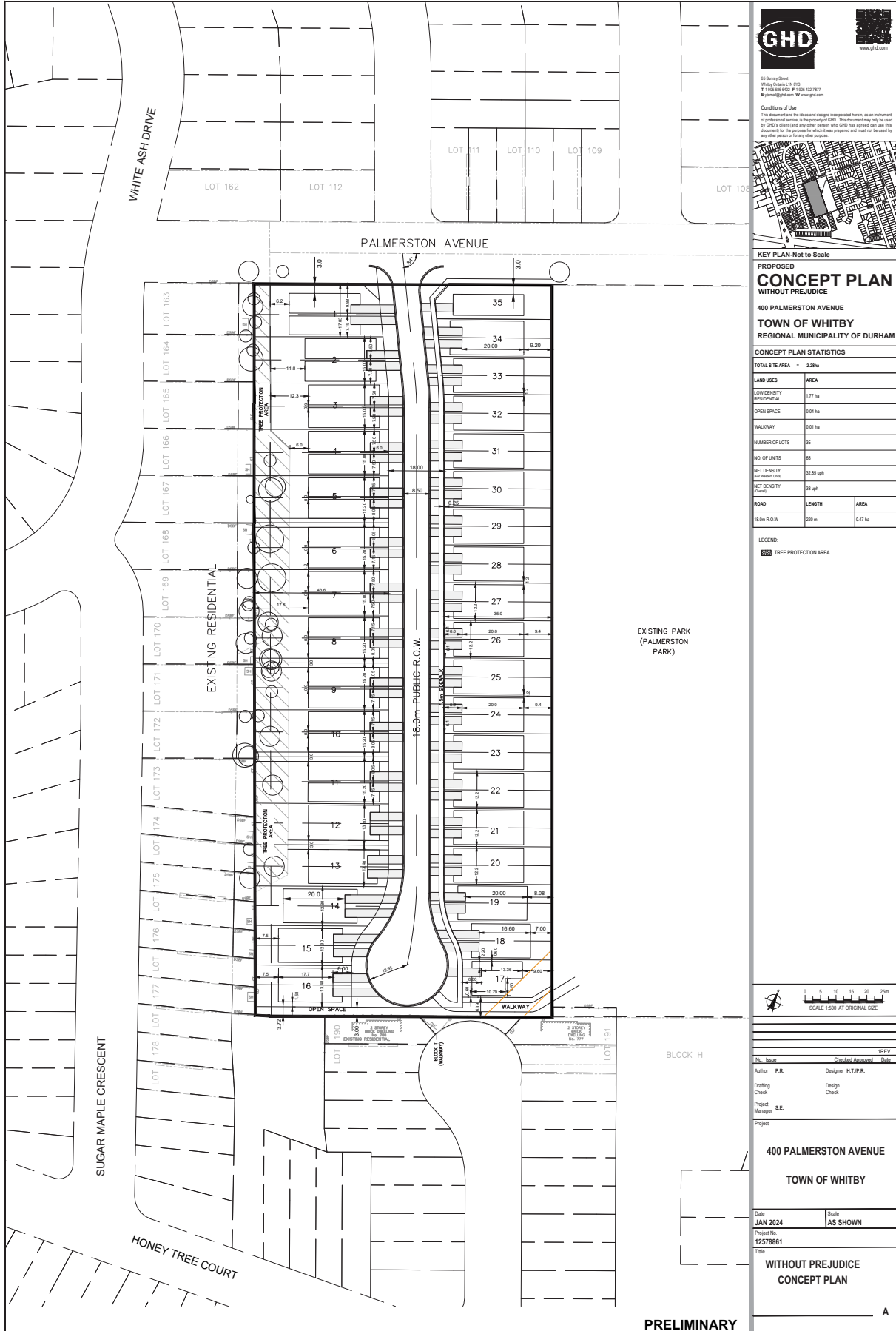

65 Survey Street  
White Plains, ON L1R 9Y3  
T 905 886 4402 F 905 432 7077  
E [info@ghd.com](mailto:info@ghd.com) W [www.ghd.com](http://www.ghd.com)

**Conditions of Use**  
This document and the data and design incorporated herein, as an instrument of professional service, is the property of GHD. This document may only be used by GHD's client and any other person who GHD has agreed can use this document for the purpose for which it was prepared and shall not be used by any other person for any other purpose.



KEY PLAN-Not to Scale

**PROPOSED  
CONCEPT PLAN  
WITHOUT PREJUDICE**  
400 PALMERSTON AVENUE  
TOWN OF WHITBY  
REGIONAL MUNICIPALITY OF DURHAM

**CONCEPT PLAN STATISTICS**

TOTAL SITE AREA	= 2.28ha	
<b>LAND USES</b>	<b>AREA</b>	
LOW DENSITY RESIDENTIAL	1.77 ha	
OPEN SPACE	0.04 ha	
WALKWAY	0.01 ha	
NUMBER OF LOTS	36	
NO. OF UNITS	88	
NET DENSITY (20 houses/lot)	32.85 uph	
NET DENSITY (36 units/lot)	38 uph	
<b>ROAD</b>	<b>LENGTH</b>	<b>AREA</b>
18.0m P.O.W.	225 m	0.47 ha

**LEGEND:**  
[Symbol] TREE PROTECTION AREA



No.	Issue	Checked	Approval	Date
1	Author: P.J.R.	Designer: M.T.P.R.		
2	Drafting	Design		
3	Check	Check		
4	Project Manager: S.E.			

**400 PALMERSTON AVENUE  
TOWN OF WHITBY**

Date: JAN 2024  
Scale: AS SHOWN  
Project No: 12578861

**WITHOUT PREJUDICE  
CONCEPT PLAN**

**PRELIMINARY**

A