

PARTIAL SITE PLAN 2
1 : 1000 A01.0

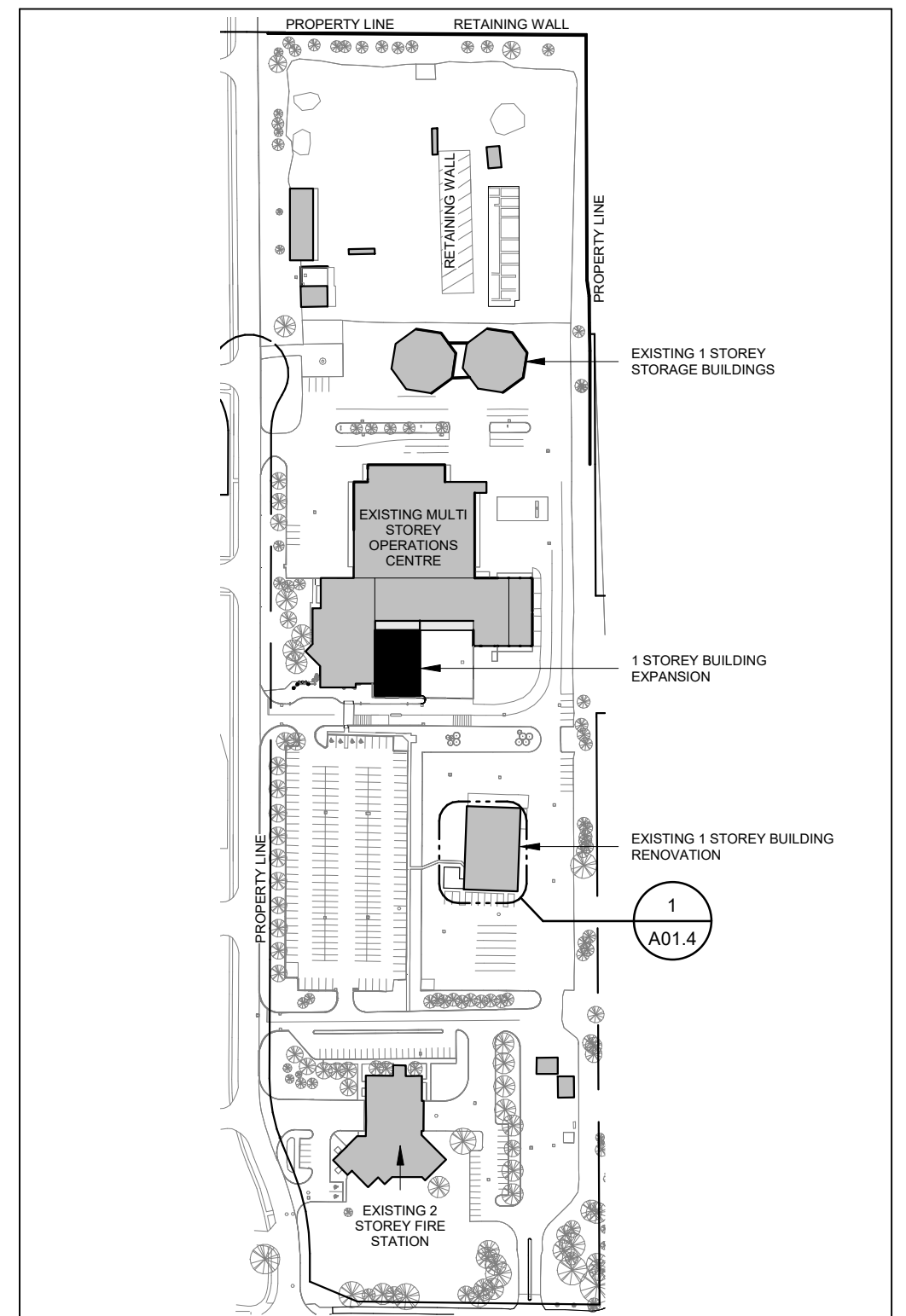

OVERALL SITE PLAN 1
1 : 3000 A01.0

mcCallumSather
Westinghouse HQ, 2nd Floor
286 Sanford Ave. N
Hamilton, ON L8L 6A1
905.526.6700
www.mccallumsather.com



No.	DESCRIPTION	DATE
3	REVISED SCHEMATIC DESIGN REPORT	24-10-11
2	RE-ISSUED FOR SCHEMATIC DESIGN	24-09-13
1	ISSUED FOR SCHEMATIC DESIGN SUBMISSION	24-08-30

DRAWING TITLE
SITE PLAN

PROJECT NAME
WHITBY OPERATIONS - PARKS ADMINISTRATION AND MAINTAINANCE

333 McKinney Drive, Whitby, ON L1R 3M2

DRAWN BY:	AB	CHECKED BY:	AA
SCALE		DATE	24/09/01
PROJECT NO.	22078	REF	
DRAWING NO.	A01.0		