

Attachment #4 Proponent's Proposed Concept Plan

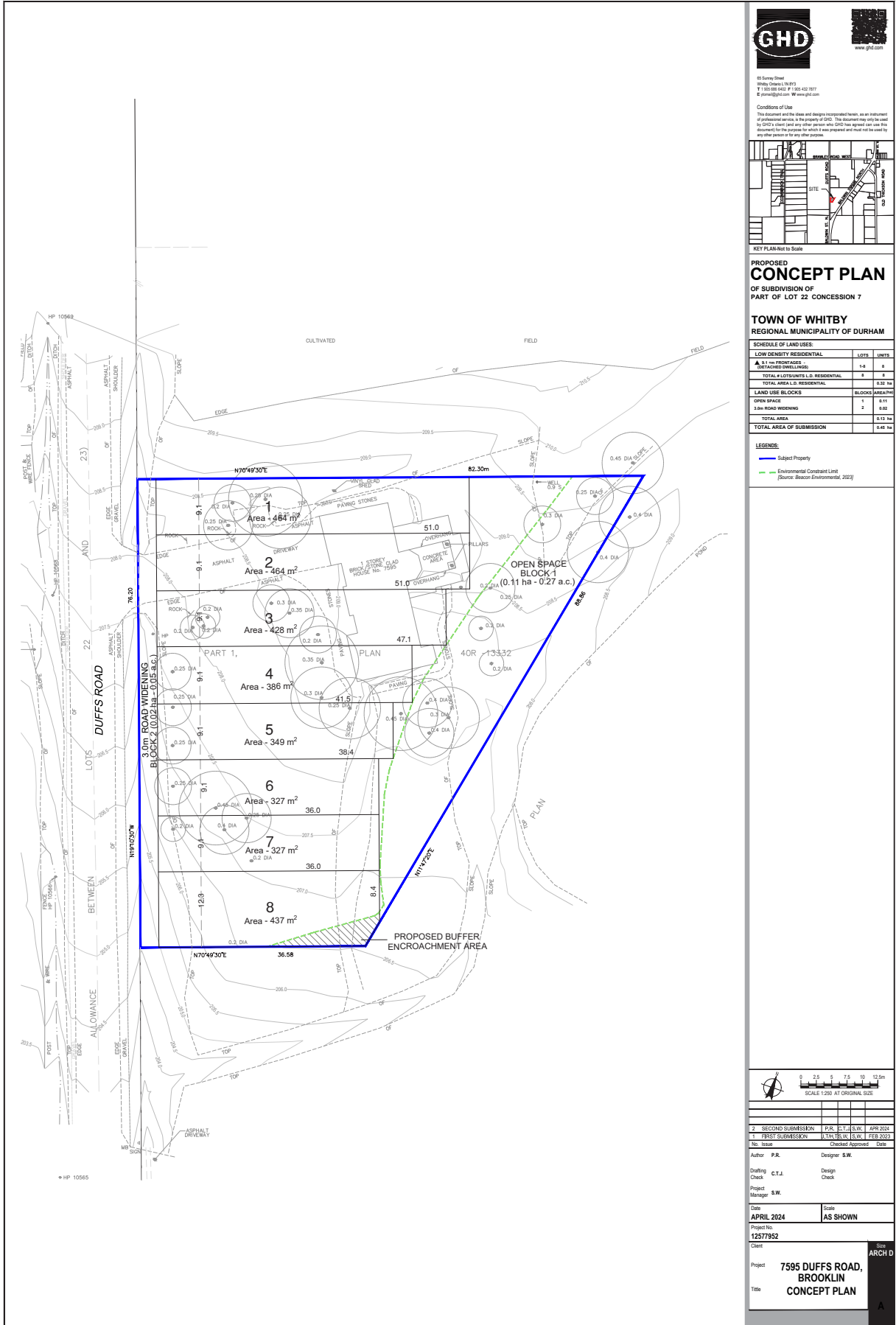

65 Sweeney Street
White Plains, NSW 2137
T: 180 000 4622 F: 1500 432 1017
E: info@ghd.com www.ghd.com

Conditions of Use
This document and the ideas and designs incorporated herein, as an instrument of professional service, is the property of GHD. This document may not be used by GHD's client and any other person who GHD has agreed can use this document for the purposes for which it was prepared and must not be used by any other person without the prior written consent of GHD.

PROPOSED CONCEPT PLAN
OF SUBDIVISION OF
PART OF LOT 22 CONCESSION 7
TOWN OF WHITBY
REGIONAL MUNICIPALITY OF DURHAM

| SCHEDULE OF LAND USES: | | LOTS | UNITS |
|---|--|------------------|-------|
| ▲ 1.1 ha FRONTAGES - DETACHED DWELLINGS | | 1-8 | 8 |
| TOTAL # LOTS/UNITS L.D. RESIDENTIAL | | 8 | 8 |
| TOTAL AREA L.D. RESIDENTIAL | | 0.22 ha | |
| LAND USE BLOCKS | | BLOCKS (AREA/HA) | |
| OPEN SPACE | | 1 | 0.11 |
| 3.0m ROAD WIDENING | | 2 | 0.02 |
| TOTAL AREA | | 0.23 ha | |
| TOTAL AREA OF SUBMISSION | | 0.45 ha | |

LEGENDS:
— Subject Property
— Environmental Constraint Limit (Source: Seacore Environmental, 2022)

Scale: 1:200 AT ORIGINAL SIZE

| No. | Issue | Checked | Approved | Date | |
|-----|-------------------|---------|----------|----------|----------|
| 2 | SECOND SUBMISSION | P.R. | C.T.J. | S.W. | APR 2024 |
| 1 | FIRST SUBMISSION | U.T.M. | S.W. | SEP 2023 | |

Author: P.R. Designer: S.W.
 Drafting: C.T.J. Design: Check
 Project Manager: S.W.

Date: **APRIL 2024** Scale: **AS SHOWN**
 Project No: 12577952
 Client: ARCH D
 Project: **7595 DUFFS ROAD, BROOKLIN CONCEPT PLAN**